

**15. Expand Central Library into Welcome Center. Redesign the First Floor Bonnell Library Space to Better Meet Current Program Requirements.**

**Goal A13**

A13. Determining appropriate next steps to improve and/or expand physical resources of main campus library (e.g., redesign of southern (Bonnell) service area and potential expansion into current Welcome Center space).

**Problem Statement**

The last major renovation to the College's main campus library was completed in 1996. The changes made at that time included: expansion of square foot through construction of a mezzanine; a major upgrade with respect to floors; furniture and fixtures; an expansion of seating and stack space; and the redesign of the library to accommodate the growing use of information technology in the delivery of library services. The redesign of the library completed in 1996 was undertaken by Hillier Architects, a prominent architectural firm with nationally-recognized expertise in library design. In virtually all respects, the library, as designed by Hillier, has worked well and continues to meet most of the College's expectations with respect to the library's layout and service. However, there are a number of issues to be addressed in the future. The Master Plan for the library developed by Hillier had a second phase which involved the expansion of the library in order to accommodate more student seating and book stack space and provide a general increase in space for library functions including bibliographic instruction, storage, and possible staff expansion. The greatest deficiencies that currently exist with respect to the main campus library at the present time include: inadequate space for bibliographic instruction; a greater need for independent and small group study areas, more computer resources for on-line research; and improved storage. In the 1996 redesign of the library, comprehensive study table and carrel access to the College's network was not provided. Tables and study carrels are not "smart" because connections to the campus network were not provided. The use of wireless technology was not considered as a possibility at the time the library was redesigned.

**Proposed Solution**

In 1997, the College converted the southwest corner of the Mint Building into the College's new student Welcome Center. This 3,500 square foot first floor space was significantly upgraded, with the expectation that at the time the Welcome Center was relocated to the ground floor of the Bonnell Building as a part of the redesign of that space to create a comprehensive Student Systems space, that the Welcome Center



space could be used as adjunct space to expand the space used for College library purposes. Potential use of this space includes: expanded student study space, a bibliographic instruction classroom, electronic references (e-library) center, and/or a permanent space for College archives and collections about the history of the College.

In addition to incorporating the Welcome Center into the Library's program space, the Bonnell first floor section of the current library should be redesigned to reflect current student needs. As a part of this redesign, the desirability of incorporating the language lab into the area should be considered. (See Goal 33.)

### **Cost Estimate**

Expand Central Library into Welcome Center

Total Construction Cost	\$263,480.00
-------------------------	--------------

Renovate Bonnell First Floor Section of Library

Total Construction Cost	\$125,000.00
-------------------------	--------------

*(Note: All estimates are in 2003 dollars. On average, construction costs increase 1% to 2% per year. See detailed cost estimate prepared by Turner Construction in Appendix A)*



# *Master Plan Update*

2003  
**H2L2**

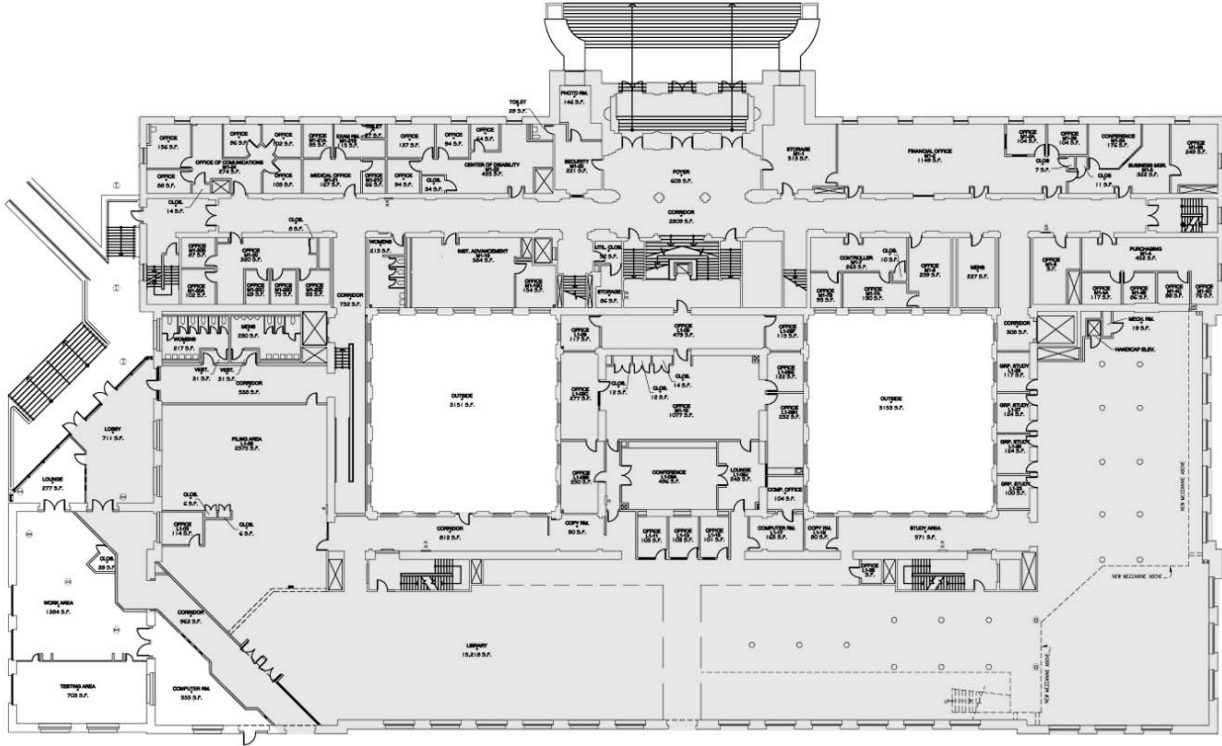

### Mint first floor

1 Expand Library Into Welcome Center

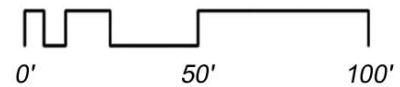

## Master Plan Update

2003  
H2L2



**Bonnell first floor**

**1** *Renovated Central Library Space*

